

HYBRID STEPPING MOTOR

MODEL: AC851505042M

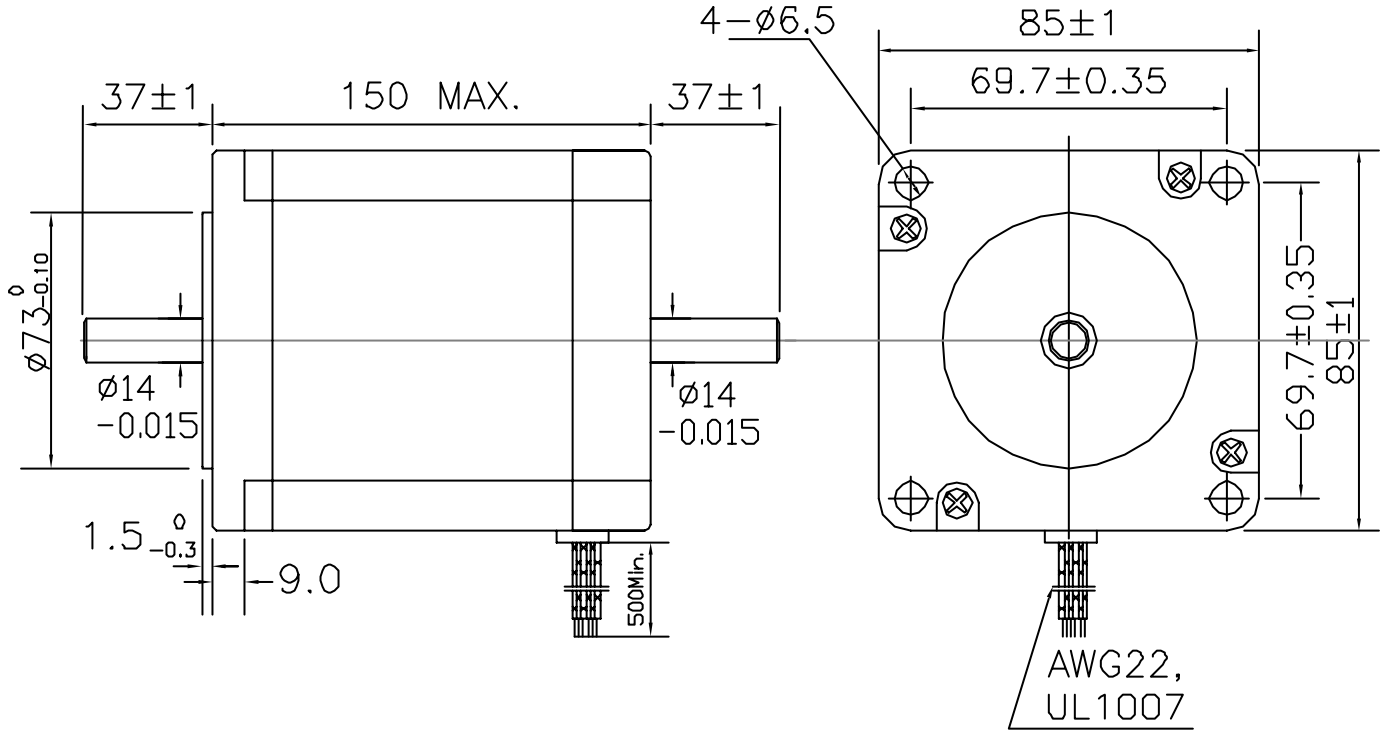

Unit: mm

SPECIFICATION

STEP ANGLE	1.8° / STEP
VOLTAGE	5V
CURRENT	4.2A/PHASE
RESISTANCE	1.20 /PHASE
INDUCTANCE	7.5 mH/PHASE
HOLDING TORQUE	6.5N.m
MOTOR LENGTH	150mm
ROTOR INERTIA	4kg.cm ²
MOTOR WEIGHT	5.25KG

WIRING DIAGRAM

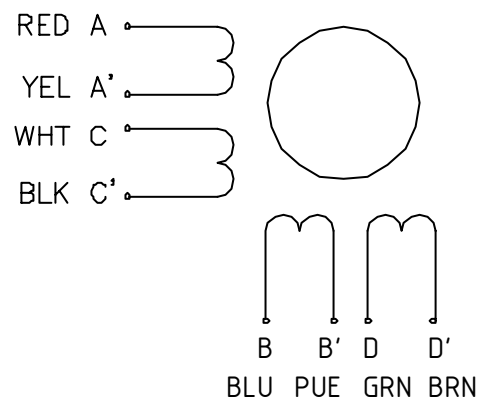

DESIGN	
CHECK	

Arc Euro Trade

Motor connections for Arc Euro Trade Stepper Motor

AC851505042: 650Ncm, 4.2A/Phase, 14mm Shaft

For BIPOLAR SERIES:

Join YELLOW A' to WHITE C and insulate connection

Join PURPLE B' to GREEN D and insulate connection

Winding One then equals RED and BLACK

Winding Two then equals BLUE and BROWN

For BIPOLAR PARALLEL:

Join RED A to WHITE C

Join YELLOW A' to BLACK C'. This is then Winding One.

Join BLUE B to GREEN D

Join PURPLE B' to BROWN D'. This is then Winding Two.

For UNIPOLAR FOUR PHASE:

Use RED A, WHITE C, BLUE B and GREEN D as the PHASE wires.

Join YELLOW A' to BLACK C', and PURPLE B' to BROWN D';

these then become the POWER connections.

The Arc Euro Trade **SMD1478250** controller will drive this motor at the rated power if set up correctly and connected to a **smoothed DC power supply rated at 2x the current setting used on the controller.**

We regret we are unable to advise you on the suitability of these motors for any application.